

# A404 Bisham Roundabout Public Consultation

## Introduction

We are seeking your views on the proposed options for updating the A404 Bisham Roundabout Junction, with the aim of:

- relieving congestion at the roundabout
- improving traffic flows
- improving road user safety and reducing accidents at the junction and on the approaches
- improving user movements through the junction
- facilitating local economic growth

Your response to the consultation will help and inform us in reaching a decision on which option to take forward.

## Why the improvements are required

The A404 forms part of the Area 3 network, connecting the M4 and the M40. It also forms an important part of the strategic diversion network for incidents on the M4, M25 and M40.

Bisham Roundabout is the only place on the A404 that drivers have to stop; providing local access to Bisham and Marlow to the west and Maidenhead via the A308 in the east. The roundabout is already operating at, or above capacity, with high levels of congestion. Delays are experienced along this section operating at, or above capacity, of the A404 on a daily basis.

## Implications of not doing anything

- no easing of daily congestion at the junction
- detrimental to local economic growth
- possible tailbacks to Handy Cross Junction with the knock on effect to the M40
- no improvement to right-turn movements.
- no improvement to facilities for pedestrians, cyclists and equestrians

## Other options which have been considered

- Grade Separated Junction (Flyover)
- Signalling the existing roundabout
- Hamburger junction
- Part-time signals at the existing roundabout

## Non-Motorised Users (NMUs)

Surveys have been undertaken which show a very low number of pedestrian and cyclist movements at this junction. Both the signalised junction and larger signalised roundabout options will be able to cater for pedestrians and cyclists within the signal timings. The Left In/Left Out option will include a pedestrian and cyclist structure; the location of such a structure is yet to be confirmed.

It is the aspiration of Highways England to review the whole of the A404 but a large scale detailed study is required. The performance and connectivity of the A404/M25/M40 is to be reviewed as part of the M25 South-West Quadrant Study that was announced in last year's Autumn Statement.

## Your feedback

We would like your views on the proposed improvements. You can do this by completing a questionnaire at either of:

- the public exhibitions (**Friday 19 and Saturday 20 June 2015**),
- online at:  
[www.highways.gov.uk/a404bisham](http://www.highways.gov.uk/a404bisham)
- by requesting a paper copy by emailing  
[area3communications@emhighways.co.uk](mailto:area3communications@emhighways.co.uk)

Please return this questionnaire to:

**Area 3 Communications, EM Highways Services, M3 Jct 9 Compound, Easton lane, Winchester, Hampshire, SO23 7TY**  
by **Saturday 12 September 2015**

## Option 1: Partial Signalised Roundabout

*Roundabout featuring partial traffic signals*

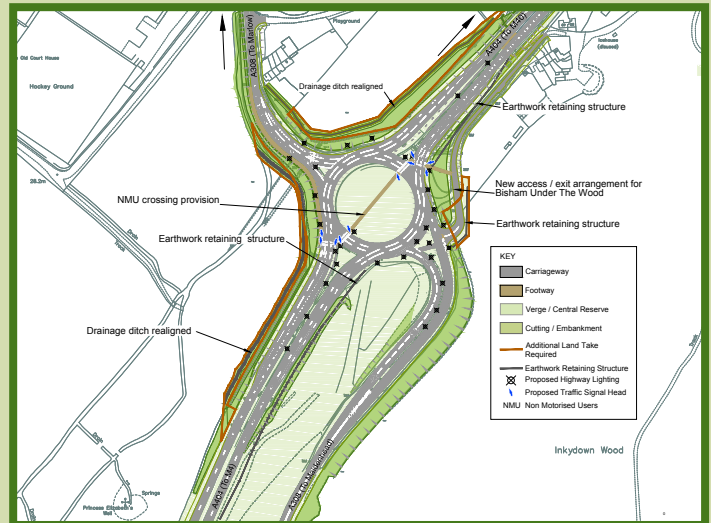

## Option 2: Left In/Left Out

*No right turns from Bisham*

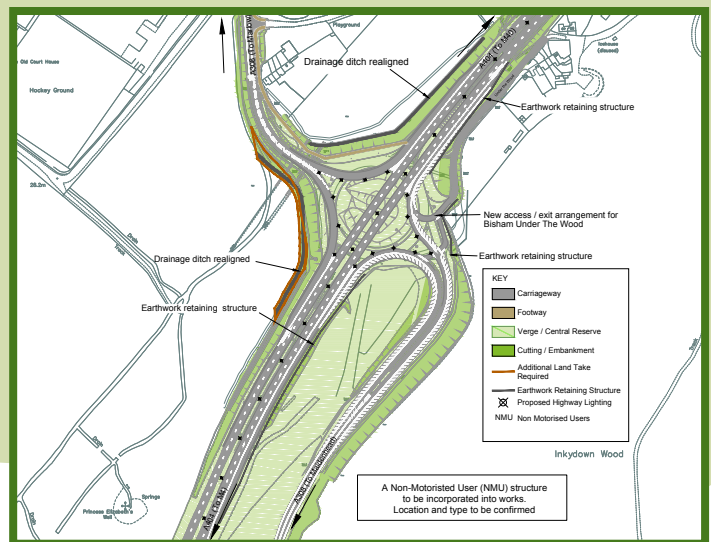

## Option 3: Signalised Junction

*Junction with traffic signals*

